

FAQ: Grace Church In-Person Indoor Service

On Sunday, November 1, our outdoor service will move indoors. We return to our church sanctuary for socially distanced, in-person worship with Holy Communion.

What should I do if I want to attend?

RSVP using the electronic form the church will send out with the weekly email blasts. Please be aware that because of social distancing requirements, space is very limited so you **MUST** register in advance.

What can I expect? Will the service feel the same?

The service format will feel very similar in that it will be Holy Eucharist Rite II. The words and actions will feel familiar. However, the experience will be very different than what you were used to pre-COVID. Pews will be blocked off to allow for social distancing (see the seating diagram included in this packet), everyone will wear a mask, congregational singing will not occur, and there will be a lot fewer people present. Additionally, certain areas on campus will be off limits (see the floor plan) and socializing will be discouraged.

What about my offering?

We encourage you to pay your pledge or gift online. There will also be a secure box at the entrance for cash or checks, but an offering plate will not be circulated.

How will communion work?

Ushers will direct you from your seat to receive communion standing at the center of the altar rail. You will receive only a wafer (not wine) from the masked and gloved clergy before returning to your seat.

Will there be singing?

The service will have accompaniment from one musician but no congregational singing.

What if I need to use a restroom?

Two restrooms will be available for emergency use. One of these restrooms is located on the sanctuary level near the clergy vesting room. The other restroom is located in the Undercroft. Both restrooms are handicap accessible. To locate either restroom, please see the floorplan.

Will you require everyone to wear a mask?

Yes. We will follow all guidelines from the CDC, diocesan authorities, and local health departments.

I've heard ventilation is important, how is Grace handling this?

Grace Church has a powerful exhaust fan in the balcony which can extract all the air from the sanctuary, allowing fresh air to circulate through the space through the windows. Our plan is to utilize the fan during services, as well as before and after to regenerate the air. To this end, you may hear some noise and/or feel a slight chill. Come prepared with a jacket or warm clothes to ensure your comfort.

Will I be safe?

No one can guarantee safety at this time. We will observe all precautions recommended by health experts, but only you can decide if you are comfortable with attending. If you attend worship, you must agree to the Covenant for Regathering in Worship, produced by the diocese, and included in this packet.

For More Information:

Join the Regathering Task Force as they host Adult Forum via Zoom from 9:30-10:15 am on Sunday, October 25. To join, logon to Zoom and enter the following **Meeting ID: 895 2186 1911** and **Password: Forum**. For additional information contact Rev. Amanda (aakes@graceepiscopalchurch.org).



Episcopal Diocese of Washington

Covenant for Regathering in Worship

In response to the COVID-19 pandemic, I promise, with God's help and to the best of my ability, to abide by the guidelines of the Diocese of Washington for participation in the life of my congregation according to the regathering phase in which my congregation is authorized to carry out its mission and ministry.

In fulfillment of our Baptismal Covenant, I will strive to:

Love my neighbor as myself

- Wear a mask or scarf over my nose and mouth at all times in church buildings, except momentarily to receive the sacrament or lead worship through an assigned speaking part.
- Only attend worship and receive communion if I am healthy and non-symptomatic with the novel coronavirus or any other transmittable disease that could compromise the health of another congregant;

Respect the dignity of every human being

- Make no physical contact with people beyond the members of my own household.
- Maintain a six foot or more distance from others in the congregation.
- Respect any requests for distance, masking, cleaning, to ensure the safety and comfort level of others, even as restrictions are reduced.

Seek and serve Christ in all people

- Trust and support the decisions of our congregational leaders.
- Stay connected with others in my community by telephone, email, video chat, or mail.

Floor Plan: Socially Distanced Seating, Entry/Exit Points, & Bathrooms

Undercroft:

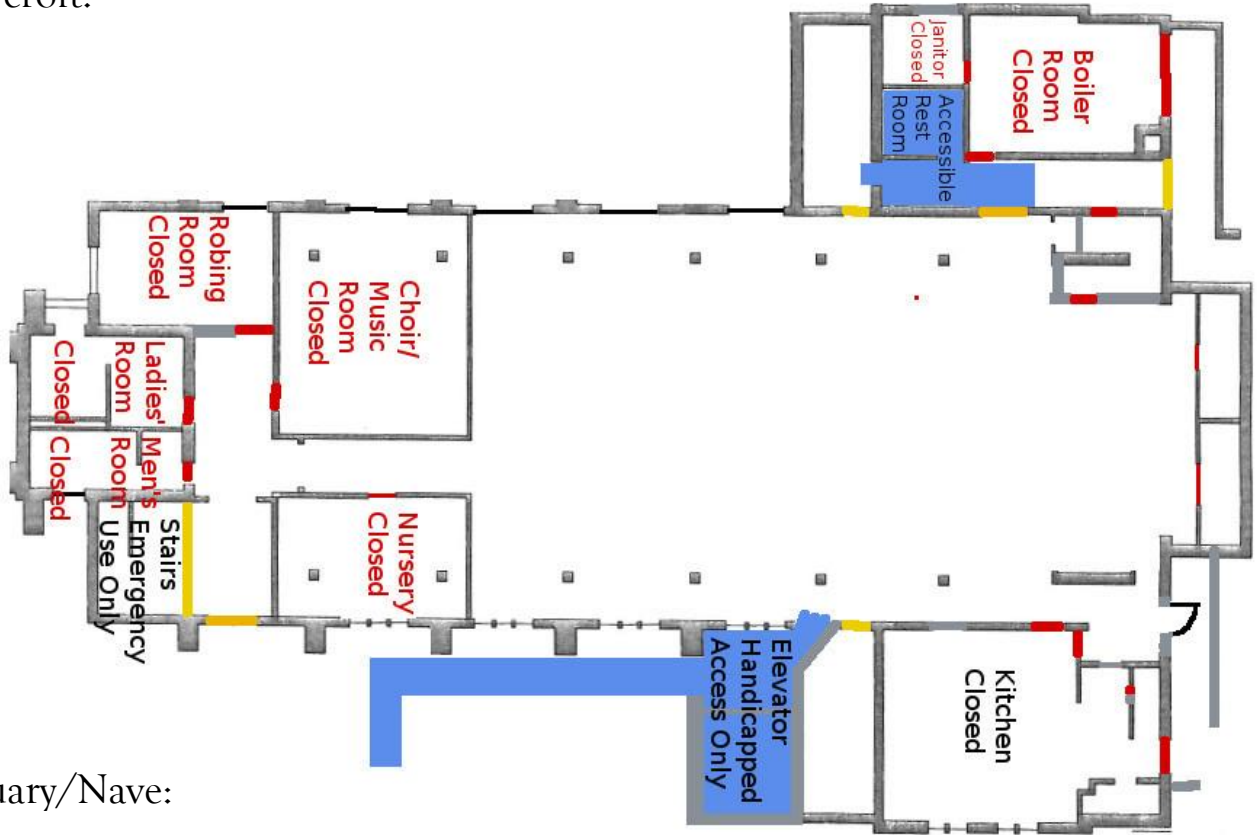

Sanctuary/Nave:

